

### EXPLOSION-PROOF LITE APPLICATIONS:

- UL/CUL Hazardous Location Class I, Division 1; Groups C & D  
Class II, Division 1; Groups E, F & G  
Class I, Division 2; Groups A, B, C & D  
Class II, Division 2; Groups E, F & G  
Class III  
Simultaneous exposure to Classes I, II & III
- Suitable for locations having deposits of readily combustible paint residues
- Marine-Outside Type (Salt water)

### BENEFITS:

- Relamp from either end of the luminaire

### FEATURES:

- Cast Aluminum construction
- Premium electronic ballast standard, where available
- .118 thick painted aluminum wire guard
- Luminaire made in Brazil by Blinda
- Supplied with lamps
- Factory sealed
- 1 year limited warranty
- Final assembly in **USA**

## SPECIFICATIONS:

### HOUSING:

Corrosion-resistant copper-free cast aluminum (less than 0.4% copper content) with painted finish is used for the housing ends and the ballast housing and other hardware. One housing end has three 3/4" NPT outlets and two plugs.

### REFLECTOR:

Fabricated of painted aluminum. Painted surfaces are two mil of white polyester enamel.

### LENSES:

Two high-impact .200 tempered pyrex glass tube enclosures, sealed to cast aluminum housing ends.

### WIRE GUARD:

Fabricated of .118 thick aluminum painted white.

### ELECTRICAL:

All ballasts and lampholders are UL Listed.

### MOUNTING:

Pendant mounting detail, see below. Includes mounting kit. Three NPT outlets on one end and adjustable bracket on the other end allow for 3 mounting positions.

### TEMPERATURE CODE:

Class I, Div. 1 - T3C (160°C); Class II, Div. 1 - T5 (100°C);  
Class III - T3C (160°C)

**( No fixture surface exposed to the hazardous atmosphere will exceed this temperature. Based on 40°C (104°F) ambient. )**

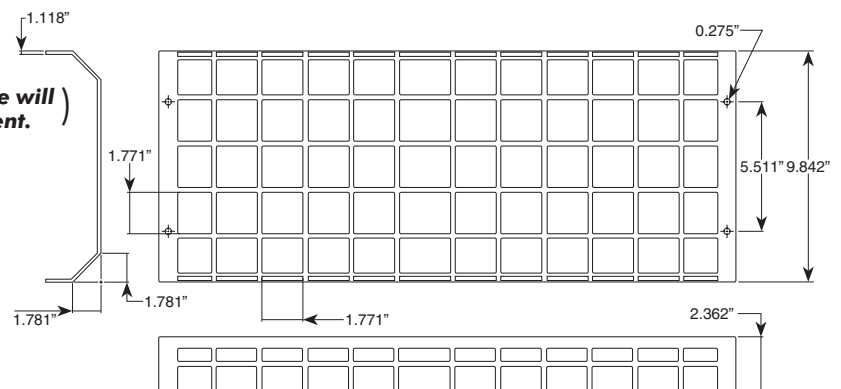
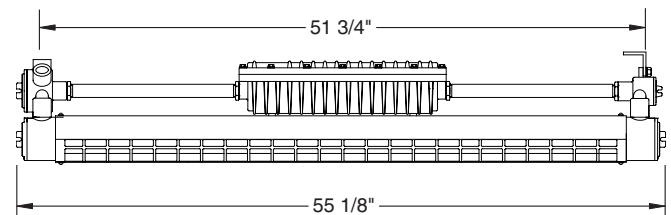
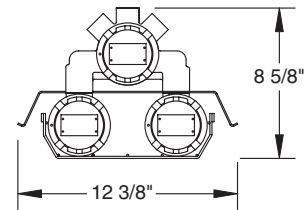

**PHOTOMETRICS:** For additional photometry, go to [paramountlighting.com](http://paramountlighting.com)  
 Model AIFX, 4FT, White Reflector and 2 Clear Tempered Pyrex Glass Lenses, 2 32W T8 Fluorescent Lamps, Lamp Lumen Rating = 2950

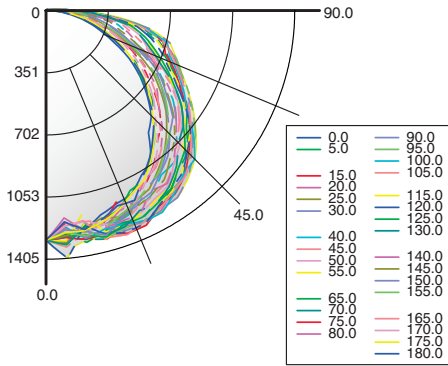

### Coefficients of Utilization, Zonal Cavity Method

Floor Cavity Reflectance: 20%

RC	.8				.7				.5				.3				.1				0
RW	.7	.5	.3	.1	.7	.5	.3	.1	.5	.3	.1	.5	.3	.1	.5	.3	.1	.5	.3	.1	0
R 0	99	99	99	99	97	97	97	97	92	92	92	88	88	88	84	84	84	82	82	82	82
C 1	88	84	79	75	86	82	78	74	78	74	71	74	71	69	71	69	67	65	65	65	65
R 2	79	72	65	59	77	70	64	59	67	61	57	64	59	56	61	57	54	52	52	52	52
3	72	62	54	48	70	61	54	48	58	52	47	55	50	46	53	49	45	43	43	43	43
4	65	54	46	40	63	53	46	40	51	44	39	49	43	39	47	42	38	36	36	36	36
5	60	48	40	34	58	47	40	34	45	39	33	44	38	33	42	37	32	31	31	31	31
6	55	43	35	30	53	42	35	29	41	34	29	39	33	29	38	32	28	26	26	26	26
7	51	39	31	26	49	38	31	26	37	30	25	36	30	25	34	29	25	23	23	23	23
8	47	36	28	23	46	35	28	23	34	27	23	33	27	22	31	26	22	20	20	20	20
9	44	33	25	20	43	32	25	20	31	25	20	30	24	20	29	24	20	18	18	18	18
10	41	30	23	18	40	29	23	18	29	22	18	28	22	18	27	22	18	16	16	16	16

### Zonal Lumen Summary

Zone	Lumens	% Lamp	% Luminaire
0-30	1061	18	22
0-40	1790	30	36
0-60	3364	57	68
0-90	4834	82	98
90-120	75	1	2
90-150	80	1	2
90-180	80	1	2
0-180	4914	83	100

Total Luminaire Optical Efficiency = 83%  
 Spacing Criterion: 0° = 1.25, 90° = 1.49

## EXPLOSION-PROOF LITE ORDERING INFORMATION:

<b>AIFX</b> SERIES	/	<b>2</b> LAMP QTY	X	<b>LAMP WATTS - LAMP TYPE</b>	-	<b>J8</b> WIRE GUARD	<b>VOLTAGE</b>
				<b>32-T8</b> 32W T8 (4FT) <b>44-T8HO</b> 44W T8/HO (4FT) <b>60-T12HO</b> 60W T12/HO (4FT) <b>110-VHO</b> 110-115W T12/VHO (4FT) <i>Supplied with lamps</i>			<b>120V-277V/60Hz STD</b> 50Hz & Other Voltages Available
<b>VOLTAGE REQUIRED AT TIME OF ORDER</b>							

Emergency Ballast N/A (Can be remote mounted in field)

Hazardous Location:    US

**Project Information:**