

## **SURFACE**

1. Remove lens by loosening securing screw, grasping lens and rotating until slots in lens and tabs on housing line up, unclip safety snell.
2. Remove housing from lid by loosening three (3) screws and rotating housing counterclockwise until housing can be removed from lid.
3. Mount lid to surface utilizing three (3) mounting holes. Use provided mounting brackets if Hazardous Location.
4. Make all necessary wiring connections.
5. Replace housing to lid with a clockwise rotation, tighten locking screws. Install lamp, replace safety snell, and lens, being sure to tighten lens securing screw.

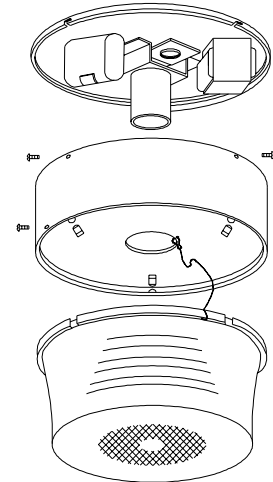

## **PENDANT**

1. Remove lens by loosening securing screw, grasping lens and rotating until slots in lens and tabs on housing line up, unclip safety snell.
2. Remove housing from lid by loosening three (3) screws, rotate housing counterclockwise until housing can be removed from lid.
3. Install locking ring to pendant. Mount luminaire to pendant, secure with locking ring.
4. Make all necessary wiring connections.
5. Replace housing to lid with a clockwise rotation, tighten locking screws. Install lamp, replace safety snell, and lens, being sure to tighten lens securing screw.

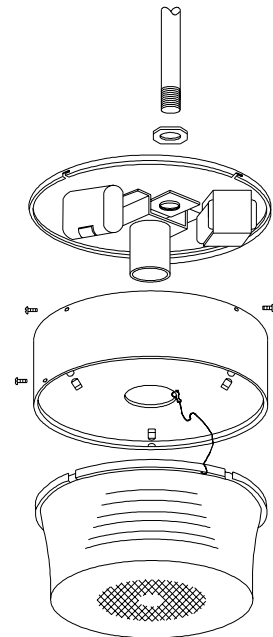

**Cleaning Instructions:** Wipe luminaire with a soft cloth slightly dampened with warm, soapy water. On stainless steel units, tightly adhering deposits may be removed by using a stainless steel polishing powder. Never use steel wool or steel brushes on stainless steel. Always rub in the directions of the polish lines.

**Note:** All luminaires to be installed by a qualified electrician.  
Mounting and electrical hardware not supplied by Paramount Industries unless otherwise noted.

REV 10/03